

$N. 87 \frac{3}{4} E. 4 \frac{1}{4}$
 $S. 28 \frac{3}{4} E. 8.8$ } 16 ps. & all.
 $N. 48 \frac{3}{4} W. 11.7$

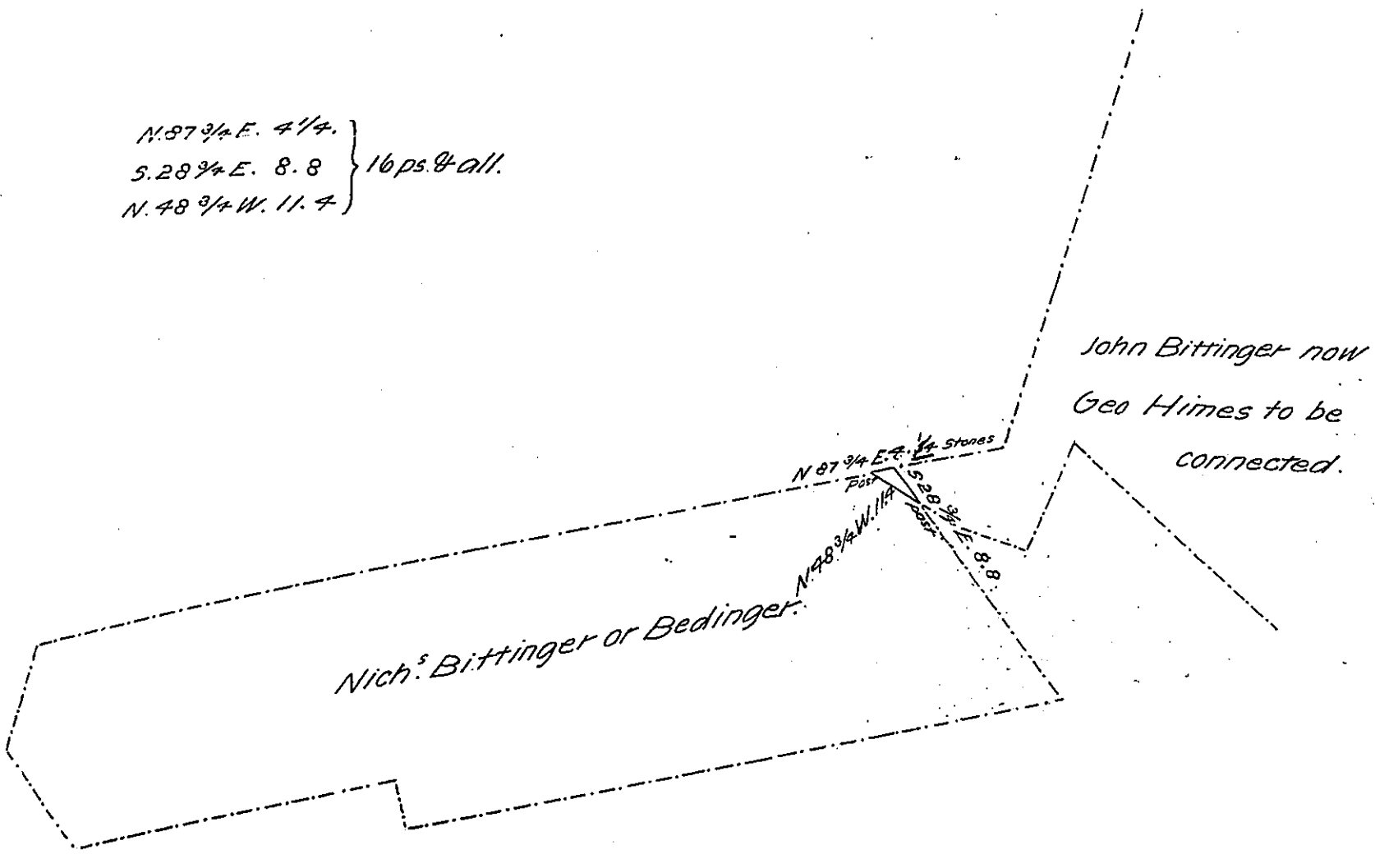

Situate in Berwick Township Adams County being
 part of a tract said to contain 53^{ac} & allw. Surveyed by
 Bedinger
 on warrant to Nicholas Bittinger dated June 19th or 18th 1759 divid-
 ed from the residue Oct. 16th 1830 for Geo Himes Containing Sixteen
 perches & allw.

By Sam^l Sloan D.S.

To Jacob Spangler Esq^r
 Surveyor Gen^l

IN TESTIMONY that the above is a copy of the original remaining on file in
 the Department of Internal Affairs of Pennsylvania, made
 conformably to an Act of Assembly approved the 16th day of
 February 1833, I have hereunto set my hand and caused
 the Seal of said Department to be affixed at Harrisburg,
 this Tenth day of January 1907.

Leac D Brown
 Secretary of Internal Affairs.